

MAX® International Faceplates

The MAX series modular faceplates combine high capacity with aesthetic enhancements that provide a fresh new look to match today's technologies. The faceplate offers pressure-release designation label covers which eliminate the need for a probe-pic or screwdriver when installing faceplate labels. The faceplates are designed to be used with the angled or flat MAX modules. Its durable finish masks minor scuffs that may occur during daily usage.

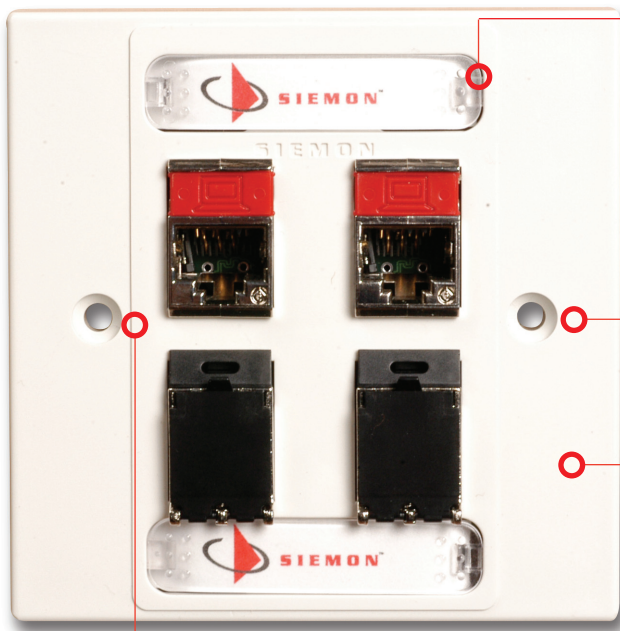

WORK AREA



Sheets of designation labels can be ordered for use with printers

A variety of faceplates and adapters are available

Faceplates available in black, white, bright white, alpine white, ivory, light ivory

Complete multimedia support

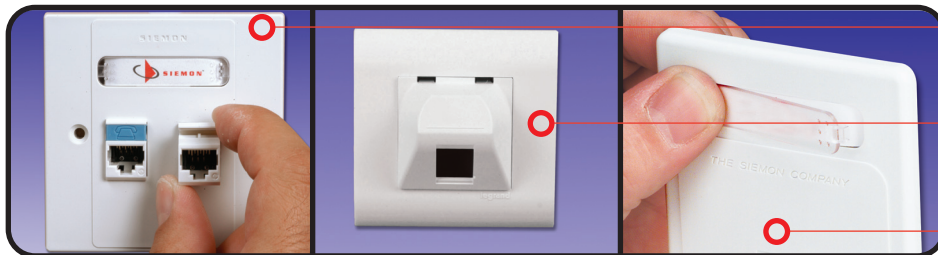

Flexible mounting tab on MAX modules allows installation from front or rear of faceplate

Siemon's angled faceplate adapters provides a secure mounting solution for use in trunking systems, faceplates and floor boxes while reducing depth needs

Most faceplates include pressure-release designation label covers for quick, tool-less removal

CONNECTING THE WORLD TO A HIGHER STANDARD

WWW.SIEMON.COM



ORDERING INFORMATION

10G MAX® British Faceplates:

Siemon's 10G MAX British faceplates are designed to provide the optimal outlet separation necessary to reduce alien crosstalk (ANEXT) between Z-MAX 6A UTP modules. MAX British faceplates are compatible with British standards (85mm x 85mm).

10GMX-BFP-02-(XX).....
2-port single gang 10G faceplate for MAX, Z-MAX or TERA® outlets



10GMX-BFP-04-(XX).....
4-port, single gang 10G faceplate for MAX, Z-MAX or TERA outlets



Use (XX) to specify color: 02 = white, 25 = bright white
Faceplates include designation labels, clear label cover, and M3.5 x 0.6 x 25 mounting screws
ⓑ Add "B" to end of part number for bulk project pack of 100 faceplates



10G MAX Australian/Italian Faceplates:

Siemon's 10G MAX International faceplates are designed to provide the optimal outlet separation necessary to reduce alien crosstalk (ANEXT) between Z-MAX 6A UTP modules. All versions include color-matching screw covers.



10GMX-HFP-02-(XX)
2-port single gang 10G horizontal Australian/Italian faceplate for MAX, Z-MAX or TERA outlets



10GMX-HFP-03-(XX)
3-port single gang 10G horizontal Australian/Italian faceplate for MAX, Z-MAX or TERA outlets



10GMX-HFP-04-(XX).....
4-port single gang 10G horizontal Australian/Italian faceplate for flat MAX, Z-MAX or TERA outlets

Use (XX) to specify color: 02 = white, 20 = ivory, 80 = light ivory
Faceplates include designation labels, clear label cover (2- and 3-port versions), and M3.5 x 0.6 x 25 mounting screws
ⓑ Add "B" to end of part number for bulk project pack of 100 faceplates



MAX® British Double Layer Faceplates:

Designed for markets that use British mounting standards (85mm x 85mm), these faceplates offer improved aesthetics via snap-on mounting screw covers. Faceplates include designation labels, clear label covers, and M3.5 x 0.6 x 25 mounting screws.



10GMX-BFPL-02-(XX) ...
2-port single gang 10G faceplate for MAX, Z-MAX or TERA outlets



MX-BFPL-01-(XX)
1-port single gang faceplate for a MAX, Z-MAX or TERA outlet



MX-BFPL-02-(XX)*
2-port single gang faceplate for MAX, Z-MAX or TERA outlets



MX-BFPL-03-(XX)*
3-port single gang faceplate for MAX, Z-MAX or TERA outlets



MX-BFPL-04-(XX)*
4-port single gang faceplate for MAX, Z-MAX or TERA outlets

Use (XX) to specify color: 02 = white, 82 = alpine white
Faceplates include designation labels, clear label cover and M3.5 x 0.6 x 25 mounting screws
Add "M" to end of part number for M4 x 0.7 x 25 mounting screws
*Not compatible with screened MAX modules

ORDERING INFORMATION

MAX® British Faceplates:

MAX British faceplates are compatible with British standards (85mm x 85mm). The faceplate is designed to accept up to six angled or flat MAX modules or TERA® outlets.



MX-BFP-S-01-(XX)
1-port single gang faceplate for a MAX, Z-MAX or TERA outlet



MX-BFP-S-02-(XX)*
2-port single gang faceplate for MAX, Z-MAX or TERA outlets



MX-BFP-S-03-(XX)*
3-port single gang faceplate for MAX, Z-MAX or TERA outlets



MX-BFP-S-04-(XX)*
4-port single gang faceplate for MAX, Z-MAX or TERA outlets



MX-BFP-S-06-(XX)* ...
6-port single gang faceplate for MAX, Z-MAX or TERA outlets

Use (XX) to specify color: 02 = white, 25 = bright white, 82 = alpine white
Faceplates include designation labels, clear label cover, and M3.5 x 0.6 x 25 mounting screws
*Not compatible with screened MAX modules

MAX Australian/Italian Faceplates:

Siemon provides mounting solutions to accommodate many international requirements. Horizontal faceplates include designation label(s), clear label covers, and color-matching screw covers.



MX-HFP-01-(XX)
1-port single gang horizontal Australian/Italian faceplate for a MAX, Z-MAX or TERA outlet



MX-HFP-02-(XX)*
2-port single gang horizontal Australian/Italian faceplate for MAX, Z-MAX or TERA outlets



MX-HFP-03-(XX)*
3-port single gang horizontal Australian/Italian faceplate for MAX, Z-MAX or TERA outlets



MX-HFP-04-(XX)*
4-port single gang horizontal Australian/Italian faceplate for MAX, Z-MAX or TERA outlets

Use (XX) to specify color: 01 = black, 02 = white, 20 = ivory, 80 = light ivory
Faceplates include designation labels, clear label cover, and M3.5 x 0.6 x 25 mounting screws
*Not compatible with screened MAX modules

TERA-MAX Faceplate:



T50-(XX)
2-port 50mm x 50mm faceplate for MAX, Z-MAX or TERA outlets



FY-MXZ-(XX)
1-port 37mm x 22mm MAX British Flexyoke housing for a MAX, Z-MAX or TERA outlet



MX-DFP-02-02*
2-port 71mm x 47mm Danish faceplate for MAX modules or TERA outlets, white

Use (XX) to specify color:
02 = white, 80 = light ivory, 82 = alpine white

Use (XX) to specify color: 02 = white, 25 = bright white
*Not compatible with screened MAX modules

ORDERING INFORMATION

WORK AREA

MAX® International Adapters:

These adapters allows one or two flat or angled MAX modules or TERA® outlets to be mounted into European faceplate openings.



MX-45-01-(XX)L
1-port 45mm x 45mm
adapter for a MAX, Z-MAX or
TERA outlet



MX-45-02-(XX)L
2-port 45mm X 45mm
adapter for MAX, Z-MAX
or TERA outlets



MX-A-(XX)*
2-port 50mm x 50mm
adapter for MAX modules or
TERA outlets



MX-RFP-S-02-02*
2-port adapter 50mm x 50mm,
white for MAX, Z-MAX or TERA
outlets

Use (XX) to specify color: 02 = white, 25 = bright white, 82 = alpine white

*Not compatible with screened MAX modules

T45-82L
1-port 45mm x 45mm
angled faceplate
adapter, alpine white for
MAX, Z-MAX or TERA
outlet



MX-JIS-(X)-(XX)-D
1-port Japanese faceplate
adapter for a flat UTP MAX
module with door

Use (X) to specify print marking:
B = blank, L = LAN

Use (XX) to specify color:
02 = white, 70 = off-white



MAX Outlet Blanks and Doors:

Blank inserts for unused ports and future growth and doors to protect outlets from outside contaminants.

MX-BL-(XX)
Blank module,
bag of 10



MX-FD-(XX)
Door assembly for
flat 6- or 8-position
MAX modules,
bag of 20



MX-AD-(XX)
Door assembly for
angled 6- or 8-position
MAX modules,
bag of 20



Use (XX) to specify color:

00 = clear (MX-AD-XX only), 01 = black, 02 = white, 04 = gray, 20 = ivory, 25 = bright white*, 80 = light ivory

*Angled doors not available in bright white. Recommend using clear or white if required.

Because we continuously improve our products, Siemon reserves the right to change specifications and availability without prior notice.

MAX®, TERA® and 10G 6A™ are trademarks of Siemon

The Americas

Watertown, CT USA
Phone (1) 860 945 4200

Europe/Middle East/Africa

Surrey, England
Phone (44) 0 1932 571771

Asia/Pacific

Shanghai, P.R. China
Phone (86) 21 6390 6778

Japan

Tokyo, Japan
Phone (81) (3) 5437 1580

For related product information request Spec Sheet(s):

MAX® 6 Modules (PROD-SS-MX6)
10G 6A™ MAX Modules (PROD-SS-MX10G6A)
10G 6A F/UTP MAX Modules (PROD-SS-10G6MXS)
Screened MAX 5e Modules (PROD-SS-MX5S)
TERA® Outlets (PROD-SS-TRA0)

WWW.SIEMON.COM

ISO 9001
CERTIFIED

ISO 14001
CERTIFIED

